

Product Catalogue 2023



in partnership with



3	BraunAbility Safety Centre	27	BraunAbility Chair Topper
4	Elap Rotating Car Seat	28	Elap Electric Programmable Boot Opener
5	BraunAbility Turnout	29	BraunAbility A Hatch / Wireless Bluetooth Remote
6	BraunAbility Turnout BIS, Ford B-MAX	30	Elap Left Foot Accelerator
7	BraunAbility Turny Low Vehicle	30	Elap Quick-Release Pedal Guard
8	BraunAbility Turny 6 Way	31	BraunAbility Carospeed Classic
9	BraunAbility Turny Orbit/HD	32	BraunAbility Carospeed Menox
10	BraunAbility Turny Evo	33	Kivi KO Wireless Over Ring
11	BraunAbility Turny Evo BIS	34	Kivi K5 Under Ring
12	BraunAbility Turny Manual & 16" Carony	35	Kivi Push Down Brake / RT12 Radial Accelerator
13	BraunAbility Carony 16" Accessories	36	Kivi CT12 Slider / LT12 Vertical Slider Controls
14	BraunAbility Carony Classic	37	Paravan Space Drive
15	BraunAbility Carony Accessories	38	Kivi PV1009 Secondary Control
16	BEV Seat, BEV Child Seat	39	BraunAbility Mini Stamp / Stamp Pedal Extensions
17	Compact Seat, Recaro Seat	40	BraunAbility Menox Pedals
18	GS Seat	41	BraunAbility Menox Steering Devices
19	BraunAbility Caroslide / BraunAbility Tilda	42	Elap Various Aids
20	BraunAbility Transfer Board 2 In 1	43	Kivi Electric Headrest
21	Kivi Manual Tip Up Plate / Electric Tip Up Plate	44	Elap E-Step
22	Elap V40X Hoist	45	Elap E-Start / Elap Indicator Extension
23	BraunAbility Carolift 100	46	BraunAbility Carobrake
24	BraunAbility Carolift 40	46	BraunAbility Parking Brake Release
25	BraunAbility Carolift 6000/6900	47	Posture Belts
26	BraunAbility Joey Lift		

After many years of supplying similar products, in 2015 Elap formed a partnership with BraunAbility and Kivi and became the sole distributor for the UK and Ireland.

This formation gave our customers access to vehicle adaptations from two of Europe's industry-leading manufacturers.

At Elap we specialise in the design, manufacture and installation of mobility products. We have been manufacturing vehicle adaptations such as the Elap Rotating Car Seat for over 40 years. As well as universal and vehicle specific adaptations, we are able to develop bespoke solutions tailored to customer needs.

We endeavour to provide the best solutions to enhance our customers independence.

We offer free demonstrations of our products and have a network of over 100 partners throughout the UK and Ireland. All our partners are invited for product training at the Elap Academy every year.

Elap is a Motability premier partner and is accredited under the ISO 9001:2015 standard.

BraunAbility is one of the world's leading vehicle adaptation providers and have a large product range including seating solutions, wheelchair stowage and driving controls. Seating solutions range from the basic manual Turnout Seat up to the Turny Evo which electrically rotates out of the vehicle and lowers down to a suitable height to allow users to transfer to and from a wheelchair with ease. Most swivel seats are available with the Carony System which turns the vehicle seat into a seating transfer system for use as a wheelchair.

Kivi manufacturers many driving aids such as under and over accelerator rings, push down/forward brakes, secondary function controls and transfer aids. They offer electronically operated accelerator rings, which when installed with mechanical braking system, provides a complete driving solution for users to drive with their hands.

Elap are a Paravan approved dealer in the UK and are certified to install all hi-tec driving devices including the Space Drive system, gear selectors and much more. Our 2021 catalogue displays many of the solutions we have to offer. For further product information or to book your free home demonstrations, please contact us on 01254 871599 or email enquiries@elap.co.uk.



quality and safety

BraunAbility Safety Centre



Everything we do is carefully tested and documented.

As safety demands are constantly increasing, we remain in the front line amongst producers of safe and reliable vehicle adaptations. Our products endure Climate, Vibration, Life Cycle, Crash and Pull tests in order to comply with standards in the vehicle industry. Certification under the quality system ISO 9001:2015 in areas of design, development and production plus our final checks and testing, provide documented peace of mind for everyone.

In May 2009, the BraunAbility Safety Centre became the first accredited Pull Test Lab in our industry, accredited by SWEDAC according to ISO/IEC 17025. In 2011, Unwin Dynamic Testing Laboratory, complete with a Crash test bed and sled.

Standards and paperwork

As the rules and regulations regarding vehicle building and fitting differ widely all over the world, we support our customers with extensive documentation. We provide customers with all the necessary certificates and documents required by road authorities and vehicle inspection agencies.

Training to ensure quality

Vehicle adaptations require great responsibility and demand a high standard of technical expertise and a strong focus on safety. The BraunAbility training department perform training at various locations or in-house at BraunAbility, free of charge.



BraunAbility Safety Centre
Accredited test laboratory
www.braunability.eu/safety



Elap Rotating Car Seat



The Elap Rotating Car Seat is designed specifically to aid entry and exit from vehicles.

Our expertise manufacturing and testing of the unit ensures we maintain our world-leading position.

The Elap Rotating Car Seat is as safe and comfortable as a standard car seat and can be installed into the front passenger or driver position of many vehicles. Additional comforts such as arm rests, neck roll supports and posture support belts are also available. The unique compact design enables the install to make no permanent alteration to the vehicle floor and allowing for the OEM seat to be re-installed if required.

Our Rotating Seats are manufactured specifically for each vehicle, please call us to confirm suitability of your vehicle.



key features

- **Bespoke design for each vehicle make and model**
- **No permanent modification to the vehicle**
- **Manual recline**
- **Optional extras available for added comfort**
- **Flammability test approved**
- **Discrete design which blends in with vehicle interior**

BraunAbility Turnout



Swivels the car seat outside the vehicle for easy access.

The Turnout swivels the car seat outside the vehicle to make transferring onto the seat easier.

The Turnout is available as manual or electric for either left or right side installation (driver or passenger side). We recommend using one of our low profile seats in combination with a Turnout to optimise head and knee/leg space.



key features

- Available for 2-door vehicles with standard rotation and 4-door vehicles with forward movement around the B-pillar while swivelling
- Available in manual and electric versions
- Available for both left and right side installations
- Combine with a Caroslide to optimise leg space
- Combine with a Tilda to optimise head and knee space
- Combine with a Carony to eliminate all lifting during transfer
- EMC and crash test approved
- CE-marked

BraunAbility Turnout BIS, Ford B-MAX



The world's first complete and fully tested swivel seat solution for the Ford B-MAX.

The BraunAbility Turnout BIS (belt in seat), Ford B-MAX is the complete solution for a small vehicle with big potential.

The kit includes the Turnout swivel base, vehicle specific mounting bracket and a seat with an integrated belt. Everything you need to make the Ford B-MAX accessible for users with limited mobility.

One of the great challenges posed by the Ford B-MAX's belt in seat design is the tremendous increase in impact forces affecting the swivel seat in the event of a crash. A challenge our engineers gladly took on. The Turnout BIS, Ford B-MAX passed all rigorous crash and pull tests with flying colours and has been given the status safe vehicle adaptation product.



The Turnout BIS, Ford B-MAX: is a complete solution including a seat with an integrated belt for driver and passenger side installations

key features

- **Crash and Pull tested and approved**
- **Seat with integrated belt**
- **Ford B-MAX specific mounting bracket**
- **CE-marked**

BraunAbility Turny® Low Vehicle



Our unique swivel seat can be installed in vehicles that were previously impossible to adapt.

With the Turny Low Vehicle we have made a big step closer to enabling you to choose a car based on your desires and not your needs.

By utilising previously unused space in the vehicle, we have designed a product that will fit in a wider range of vehicles, provide excellent leg and head space as well as vastly increase comfort.



The completely new design takes seating comfort to a new level.

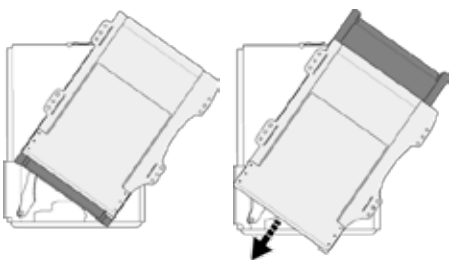

ReXtension™
By reversing the seat halfway through the swivel process, valuable space has been created for users legs and feet. This is one of the key features that now makes it possible to choose vehicles that previously have been considered too small and narrow to install.

key features

- Meets and exceeds current directives
- Increased head space
- Significantly increased leg space
- Fits in more vehicle models
- Complete new innovative design
- Improved seating comfort
- Optimised interior space through ability to program
- Can be installed in the driver and passenger position of most vehicles

BraunAbility Turny® 6-Way



A versatile seat base for easy transfer to and from a wheelchair whilst inside the vehicle.

The BraunAbility Turny 6-Way enables users to safely transfer from a wheelchair to car seat whilst inside a vehicle.

The Turny 6-Way allows users to move the driver or passenger seat backwards, rotate it and adjust the height to bring the seat in line with the wheelchair. The BraunAbility Turny 6-Way has passed crash tests, extreme climates and a lifetime of usage.

An optional foot rest is available.



key features

- Easy to operate with only three toggle switches
- Blends in well with the vehicles interior
- The original seat can be mounted on top of the Turny 6-way
- Available in both left and right models

Height adjustment	-177mm
Rotation	-140° / 120°
Horizontal travel	-704mm
Max Weight Capacity	-180kg

BraunAbility Turny® Orbit/HD



The Turny Orbit/HD enables users to get in and out of the vehicle with ease by bringing the entire car seat outside of the vehicle.

The Turny swivels the car seat outside of the vehicle and lowers to a suitable position for a user to transfer to or from a wheelchair.

The Turny Orbit has electrically operated swivelling, lifting and lowering. All movements of Turny Orbit are operated by a hand-held control.

The Swivelling movement of the Turny HD is manually operated. The down/up movement is powered and operated by a hand-held control.



key features

- Available with 300mm or 480mm vertical travel
- Easily accessible manual override
- No adapter plate is needed for the BEV and Compact seat
- EMC and crash test approved
- CE-marked

BraunAbility Turny® EVO



The Turny Evo is a seat lift that will allow the user to get seated outside the vehicle, before being comfortably transferred to a safe position inside.

Having the car seat completely outside of the vehicle and at a height of choice can be very helpful when getting seated or making the transfer from a mobility device.

The unique feature of the Turny Evo is its programmable movement path. The Turny Evo can be individually tailored to each vehicle ensuring leg room is constantly optimised throughout the rotation.



key features

- Programmable movement
- Advanced pinch protection
- Unlimited backrest inclination
- Powered seat adjustment inside the vehicle
- Operated by a informative hand-held remote
- Easily accessible manual override
- 390mm vertical travel
- EMC and crash test approved
- CE-marked
- Optional wireless remote via app (see page 29 for more details)

BraunAbility Turny® EVO BIS



The Turny Evo BIS is ideal for 2nd row installations where the seat belt is built into the OEM seat.

With the use of an integrated seat belt, when the user moves the Turny Evo forwards or backwards the seat belt moves with them, always maintaining the perfect seat belt geometry.

The seat belt is closer for the user to reach than one attached to the C pillar.

key features

- Integrated seat belts
- Programmable movement
- Advanced pinch protection
- Unlimited backrest inclination
- Operated by an informative hand-held remote
- Easily accessible manual override
- 390mm vertical travel
- EMC and crash test approved
- CE-marked
- Optional wireless remote via app (see page 29 for more details)



BraunAbility Turny® Manual & 16" Carony



The Carony system enables users to transfer from wheelchair to car seat without lifting. The Carony eliminates the difficulties of transferring onto a car seat.

The seat is as safe and comfortable as a standard car seat and is as versatile and easy to use as a standard wheelchair.

Just three easy steps to operate, swivel, dock and slide.

key features

- Everything can be adjusted to meet the users requirements such as the recline, arm rests and foot rests
- Built in attendant handles and brake which can be folded away
- Improved comfort
- Variety of optional extras available including torso, thigh support and head supports, hip belt, harness, belt deflector, anti tip protection and many more



BraunAbility Carony® Accessories



Torso Support

Fitted on the backrest to provide support for the upper body.



Thigh Support

Provides extra support for the users legs



Universal Elastic Strap

Supportive strap for use on chest, abdomen, thighs or lower legs.



Calf / heel Support

Supports the lower legs and control flexion without risk of bruising.



4 Point Shoulder Harness

The Shoulder Harness has a body-contouring shape for optimal support and a comfortable fit.



Childs Headrest

The Childs Headrest is much lower than the standard version. It is very flexible and allows both height and width adjustments according to the child's needs.



Childs Armrests

Armrests that are closer together to better suit small bodies.



Elevating Leg Support

Elevating leg support for Carony System.



Belt Deflector

This simple yet vital device helps place the seat belt the correct angle across the shoulder.



Anti Tip Protection

Prevents a seat from tipping whilst in use with a Carony system.

BraunAbility Carony® Classic



The Carony Classic eliminates the difficulties of transferring between a wheelchair and car seat.

The car seat transfer system has been one of BraunAbility's flagship products for nearly 30 years.

An assistant swivels the seated user outside of the vehicle and docks the Carony chassis. The entire seat then easily slides onto the chassis and becomes a seat transfer system.



key features

- Available in either 12 or 24 inch rear wheels
- 24 inch rear wheels are quick release
- The user remains comfortably seated whilst transferring from the Carony system into the vehicle
- Suitable for children and adults
- Available for left and right side installations
- Approved as a medical device
- Crash tested and approved according to ISO 7176 and ISO 10542
- Fire resistant seats
- CE-marked

BraunAbility Carony® Accessories



Calf and Leg Support
Provides extra support for users legs.



BEV Side Support
The side support is placed behind the backrest cushion or under the seat cushion for support.



BEV Backrest Seat Cushion
Replacement for original backrest and seat cushions.



Head Support (Neck roll)
Provides extra support for users head and neck.



Heal Support
Heal Support for Carony System.



Lumbar Support
The Lumbar Support is placed under the backrest cushion or under the seat cushion for support.



Comfort Headrest
Comfort Headrest for BEV seat.



Elevating Leg Support
Elevating leg support for Carony System.



Children's Foot Support
Children's Foot Support for Carony System.



Anti Tip Protection
Prevents a seat from tipping whilst in use with a Carony system.

BEV seat



The BEV seat is an ergonomic low built seat which is specifically designed to be adapted to users needs with a variety seat options.

The seat has low, flat sides which enables users to easily transfer to and from.

The cushions in the backrest and base are removable, to enable a variety of extras such as side, thigh and lumbar supports to be fitted. The cushions can be easily removed from their velcro fasteners for cleaning or replacement.

The BEV seat is compatible with the Turnout, Turny Low Vehicle, Turny Orbit/HD, Turny Evo, Carony Classic and Carony Go.

key features

- Low profile
- Highly adaptable
- Optional armrests
- Manual recline

BEV Kids seat

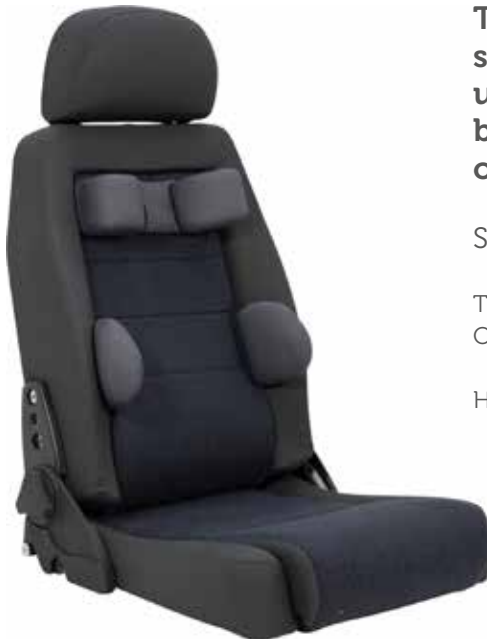

The BEV Kids seat is a smaller version of the BEV seat which is specifically designed for children or users with reduced height. The ergonomic seat can be adapted to meet individual needs using a variety of BEV options.

Seat length: 400-450 mm. Seat width: 440 mm.

The BEV seat is compatible with the Turnout, Turny Low Vehicle, Turny Orbit/HD, Turny Evo and the Carony system.

Headrest, neck support and body support are included.

key features

- Low built
- Highly adaptable
- Optional armrests
- Manual recline

Compact seat



The most popular design feature of the Compact seat is its ability to blend in with the vehicle interior.

The Compact seat is compatible with the Turnout, Turny Orbit/HD, Turny Evo, Carony Classic and Carony Go.

PLEASE NOTE! Compact Seat does NOT have a release catch that allows the backrest to fold forward.

key features

- Compatible with Turnout, Turny HD/Orbit, Turny Evo, Carony Classic and Go
- Extra comfort with support for both the users torso and thighs
- Blends in with the vehicle interior
- Adjustable recline
- Optional armrests
- Fire tested according to wheelchair regulations
- Tested and approved for use as wheelchair seat and car seat
- Low profile
- CE-marked

Recaro seat



The Recaro Specialist L seat is a low profile bucket seat. The Recaro seat has an extendable base and robust side bolsters which ensure a straight and comfortable seating position. The seat has manual recline and an adjustable backrest to make accessing the rear of a three-door vehicle easier.

The Recaro seat is compatible with the Turnout, Turny Low Vehicle, Turny Orbit/HD, Turny Evo, Carony Classic and Carony Go.

key features

- Compatible with Turnout, Turny HD/Orbit, TLV, Turny Evo, Carony Classic and Go
- Bucket seat design
- Ergonomic driving position
- Manual recline
- Optional armrests

GS seat



The GS Seat has been developed with the growing child in mind. Comfort and safety has been the primary focus.

Almost everything on the GS seat can be adjusted for the user's needs. From the seat depth to the position of each arm rest in three dimensions. The GS seat has a variety of accessories which help further adapt the seat to a user's specific needs.

The GS seat can be adjusted to provide comfortable and safe seating between the ages 3 and 12 depending on body development.

The GS seat is tested and approved according to M1 standards.

key features

- Backrest height 68 cm (84 cm with back extension)
- Seat depth: 22-45 cm
- Positioning belt - adjustment: 24 cm
- Headrest - height adjustment: 24 cm
- Leg Support - width adjustable by: 12 cm (6 cm each)
- Side support - height adjustment: 7.5 cm
- Side support - width adjustable by: 13 cm (6.5 cm each)
- Space between side support: 17 – 30 cm
- Armrests - height adjustment: 9.5cm
- Adjustable armrests angle
- Footrest - height adjustment: 23 – 40 cm from top of seat cushion
- Belt deflector - height adjustment: 15 cm
- Push handle with Carony system



BraunAbility Caroslide



The Caroslide (extended seat runners) is a powered seat slider that can provide extra leg space when swivelling in and out of a vehicle and when seated inside the vehicle.

The Caroslide can also be used to manoeuvre the seat to a comfortable seating position inside the vehicle.

The Caroslide works well with the BEV seat, Compact seat and the Recaro seat.

The Caroslide can be installed in both the left or right side of a vehicle with a maximum travel of 24cm.

BraunAbility Tilda



The Tilda enables a seat to be tilted up to 15° backwards, in three intervals.

This product provides extra head space for users when sliding the seat between the Carony and the Turnout or Turny Evo swivel seat inside the vehicle.

The optional footrest provides additional assistance when transferring a users feet over the vehicle door sill. The Tilda also provides a safe and comfortable seating position.

Crash tested in position 0, upright position and position 1, first tilt position. The Tilda can be installed in both left or right side of a vehicle.

BraunAbility 2 in 1 Transfer Board



The Transfer Board is a simple solution to enable users to transfer to and from a car seat. The board folds out next to the seat and provides a streamline platform to bridge the gap next to the seat.

The Transfer Board uses the same bolt holes already in the vehicle, meaning there are no permanent alterations made during install.

When not in use the board can be flipped up, and folded discretely behind the seat or removed from the fitted bracket.

The Transfer Board can be installed on both sides of the vehicle.



key features

- Lightweight 2 in 1 solution – foldable and removable
- No permanent alterations
- Weight capacity- 140kg
- Suitable for driver or passenger side
- Angle adjustable board $\pm 10^\circ$
- Height adjustable
- The Transfer Board can be modified to suit the end users' requirements
- Easy to use

Kivi Manual Tip Up Plate



The Manual Tip Up Plate enables users to transfer onto a car seat with ease.

The Tip Up Plate can be installed in vehicles with three and five doors, on both the right or left front seats.

key features

- Weight capacity- 120kg
- Suitable for driver or passenger side
- Available in removable or foldable versions
- Strong and solid construction

Kivi Electric Tip Up Plate



The Electric Tip Up Plate is suitable for users that require assistance transferring onto a car seat. The plate can be adjusted to a height of the users choice.

The Electric Tip Up Plate can be installed in vehicles with three and five doors, on both the right or left front seats.

key features

- Weight capacity- 120kg
- Suitable for driver or passenger side
- Operated via a 2 function remote

Elap V40X Hoist



The Elap V40X Wheelchair and Scooter Hoist allows users to move a wheelchair/scooter in and out of a vehicle via the touch of a button.

The Elap V40X 2 way hoist is a simple and cost-effective loading solution for wheelchairs and scooters.

The powerful electric motor and solid construction can accommodate a load of up to 40kg with ease. The boom can be folded flat against the boot floor when not in use.

The V40X is a universal boot hoist which can be installed in either the left or right side of many vehicles. Loading and unloading a wheelchair is simple, just press the up or down button on the wired remote control.



key features

- Lifts up to 40kg
- Compact 2 way hoist
- Automatic locking boom
- Single handed loading
- Boom folds down flat when not being used
- Corded remote control operation
- Universal installation
- Limited space required for installation
- Suitable for vehicles with false floors

BraunAbility Carolift® 100



The Carolift 100 is a 4 way powered boot hoist designed to lift a wide range of mobility scooters and powerchairs.

The Carolift 100 is flexible as it can be installed on either the left or right side of the boot in a variety of vehicles.

When the hoist is not in use the arm can be quick released off to allow for more storage space.



key features

- 100kg lifting capacity
- 4 way powered with remote
- 360 degree rotation
- Quick release arm
- Crash tested
- Climate tested
- Can be installed on the left or right of the boot
- Quick installation
- Transferable
- Optional wireless remote via app (see page 29 for more details)

BraunAbility Carolift® 40



The Carolift 40 is a flexible wheelchair hoist that fits in almost all car models.

The Carolift 40 has a flexible arm which can manoeuvre wheelchairs through narrow openings whilst still retaining the ability to reach beyond wide bumpers.

Unlike hoists with fixed arms, the Carolift can pick up wheelchairs from the pavement beside the vehicle.



key features

- Lifts up to 40 kg
- Flexible hoist arm folds both directions
- Powered lifting/lowering and with manual rotation
- Assisted folding to and from storage position
- Fits almost all car models
- Easy installation thanks to smart mounting base
- One size fits all, no need to cut or work the hoist
- EMC and crash test approved
- CE-marked

BraunAbility Carolift® 6000/6900



The Carolift 6000/6900 is a universal telescopic hoist which can lift mobility devices up to 181kg.

The off-set arm allows the hoist to access mobility devices from the side of the vehicle.

The Carolift 6000/69000 has powered lift and swivel which is controlled by a wired remote control.



key features

- Lifts up to 181 kg
- Powered lift and swivel
- All motors are fully programmable for speed, acceleration and deceleration
- Fits almost all vehicle models
- Adjustable height, rotation and hoist head angle/length
- Adjustable inner and outer rotation stop position
- Quick release foldable hoist arm available as an optional extra
- EMC and crash test approved
- CE-marked

BraunAbility Joey Lift



A small platform lift for lifting and stowing mobility devices.

The Joey Lift can lift and stow an unoccupied scooter/powerchair inside a vehicle at a touch of a button.

Simply roll your mobility device onto the platform, press the button on the wired remote control, and the Joey lift will lift and stow the mobility device.

Optional securement belts and wheel chocks are available.



key features

- Lifts up to 159 kg
- Effortless operation due to the fully powered operation
- Gentle slope and textured finish on platform allows easy roll or drive on/off - no reversing necessary
- No modifications needed to be made to mobility devices
- Manual Backup System and Industry Exclusive Obstruction Safety Sensing
- Includes securement straps for safety
- Powered by the vehicle's battery
- Illuminated platform and handset
- EMC and Crash test approved
- CE-marked

BraunAbility Chair Topper



Stow or retrieve your wheelchair in 30 seconds.

The Chair Topper can lift and store a foldable wheelchair within approximately 30 seconds.

The weather-tight compartment weighs 55 kg and can be mounted onto most vehicles. The total weight, including wheelchair, does not exceed 75 kg.

The roof box adds 54 cm total height to the vehicle and is available in driver and passenger-side models.



key features

- Operated by a hand held remote control
- Complete operation only takes approximately 30 seconds
- Aluminium frame. Base/top in ABS plastic
- Available in driver and passenger-side models
- Low friction side tracks
- Sealed motors
- Fully enclosed to be weather resistant
- Integrated manual backup system
- Optional wireless remote via app (see page 29 for more details)

Elap Electric Programmable Boot Opener



The Elap Electric Programmable Boot Opener is the ideal solution for those vehicles that haven't had the option fitted during build.

The operation couldn't be simpler, open and close the boot via the touch of a button. Two buttons are supplied with the kit, one for the dash and one to fit on the boot itself. In some vehicles, the original key fob can be used to operate the open and close function.

We also offer a foot sensor as an optional extra where the boot opener is operated by waving your foot under the bumper.



key features

- Simple, smooth operation
- Operation can be installed into vehicle key fob on certain vehicles
- Can be programmed to stop at a set height
- Manual override
- Intelligent anti pinch protection

BraunAbility A-Hatch



Optional wireless remote

The A-Hatch is a device that assists in opening and closing the rear hatch.

Operated by a switch or by an optional wireless remote control.

The hatch can still be manually opened.

BraunAbility Wireless Bluetooth Remote



By adding our Bluetooth® receiver you can control your BraunAbility product via your smartphone or similar device using the BraunAbility Remote app.

Compatible with the Turny Evo, Turny Low Vehicle and Chair Topper.

App available for iOS & Android devices.

Elap Left Foot Accelerator



The Elap Left Foot Accelerator enables users to accelerate with their left foot.

The Elap Quick-Release Left Foot Accelerator offers a spring-loaded accelerator pedal to enable maximum acceleration whilst providing an angled guard for optimum protection.

The Left Foot Accelerator is a simple yet effective adaptation that provides operation of the conventional accelerator pedal using the left foot. This is positioned to the left side of the brake pedal. The system is neatly designed, quick to click in place and easily removed to allow for conventional, unobstructed driving.

key features

- Quick-release function
- Vehicle can be driven conventionally in seconds
- Anti-Slip pedal
- Guard covers the OEM pedal
- Adjustable to suit the vehicle pedals

Elap Quick-Release Pedal Guard



The Elap Quick-Release Pedal Guard was designed to prevent accidental use of the foot pedals.

The Elap Quick-Release Pedal Guard can prevent accidental use of pedals when using hand controls.

The Elap Quick-Release Pedal Guard is floor-mounted and available to cover either the accelerator or both accelerator and brake pedals.

The guard is a simple yet effective adaptation which is quick and easy to remove to allow for conventional, unobstructed driving.

key features

- Prevents accidental use of pedals when using hand controls
- Easily removed to allow normal pedal use
- Available in different sizes for one or both pedals

BraunAbility Carospeed® Classic



The BraunAbility Carospeed Classic enables users to accelerate and brake with their hands.

The Carospeed Classic is a universal floor-mounted control that moves the accelerator and brake pedals to an intuitive hand control. Simply pull to accelerate and push to brake.

The Carospeed Classic comes with hill hold function to hold the brake pedal down. Cruise control is available as an optional extra.

The Carospeed Classic is available in three versions: standard model with only the basic accelerator and brake functions. Indicator model with integral indicators and E model with integral electrical functions which include indicators, windscreen wipers, washers, horn, high and low beam and set function for cruise control.



key features

- **Sturdy construction that provides a quality driving experience**
- **Designed to blend in with the vehicle interior**
- **Can be installed in most vehicles**
- **Neat installation, no holes need to be drilled into the vehicle and cables are concealed under the carpet and behind panels**
- **Recommended for use with automatic gearboxes only**

BraunAbility Carospeed® Menox



Stylish and ergonomic hand control for acceleration and brake.

The Carospeed Menox is a universal floor-mounted hand control that moves the accelerator and brake pedals to an intuitive hand control. Simply pull to accelerate and push to brake.

The Carospeed Menox comes with hill hold function to hold the brake pedal down.



key features

- Ergonomic motion that conforms to a users natural movement
- Highly adjustable to individual needs
- Available in many colours to match vehicle interiors
- Can be installed in most vehicles
- Neat installation, no holes need to be drilled into the vehicle and cables are concealed under the carpet and behind panels
- Recommended for use with automatic gearboxes only

Kivi KO Wireless Over Ring



The new KO Wireless Over Ring provides improved technology and is easy to use and install.

The Wireless Over Ring can be installed in vehicles with automatic transmission.

Two versions are available: fixed or removable. The fixed version is fixed to the steering wheel with a wheel adapter, the second can be easily removed when not in use.

Both accelerator rings can be paired with a push down or push forward braking system.

Turn off the ring via a button to drive conventionally.



fixed



removable



push forward brake



push down brake

key features

- Easy operation, simply push the ring
- Power saving acceleration mode
- Brake supplied with hill hold, economiser and horn function
- Available with push down or push forward brake lever
- Steering column can still be adjusted with push down brake system
- One simple on/off switch for conventional driving

Kivi K5 Under Ring



The K5 Under Ring allows users to accelerate with their hands.

The Under Ring transfers the accelerator control from the pedal to the steering wheel, allowing users to accelerate with their hands.

The Under Ring can be installed in vehicles with automatic transmission.

The unique, easy-fit, two-way acceleration ring was developed to match vehicle steering wheels and allow extra space.

There are 2 other styles available:

- K4- pull towards to accelerate
- K6- push away to accelerate

The Under Ring can be paired with a push down or push forward braking system.

Turn off the ring via a button to drive conventionally.

key features

- Easy operation by pulling or pushing the ring
- Power Saving Acceleration Mode
- Brake supplied with hill holder and horn function
- Available with push down and push forward brake lever.
- One simple on/off switch for conventional driving
- 2 ring style options available: Easy-fit & original



K5 easy fit



K5 original



push forward brake



push down brake

Kivi Push Down Brake



The Kivi Push Down Brake enables the user to brake with a short downward motion.

All the transmission rods are hidden behind the vehicle panels so it does not affect the users knee space.

key features

- Hill hold function
- Economy function
- Most of brake lever hidden behind vehicle panels

Kivi RT12 Radial Accelerator



Kivi RT12 Radial Accelerator allows users to accelerate with their hands.

Simply, push the grip down to accelerate and push it towards the dash to brake.

key features

- Easy acceleration by pressing down on the lever
- Easy braking by pushing the lever towards the dashboard
- CE Marked
- EMC approved
- Available in Interface Motor

Kivi CT12 Slider Control



The CT12 Slider Control transfers the acceleration and brake functions from the pedals to the wheel.

The CT12 consists of a push brake lever and a slider. Push the lever to the dashboard to brake, move the slider outwards to accelerate. The CT12 can be attached to the right or left of the steering column in many vehicles, depending on the users requirements.

Installation of the CT12 does not affect the airbag opening, does not prevent access to the driving controls and does not prevent users to driving the vehicle conventionally.

key features

- Easy operation by sliding or pushing the lever
- Brake supplied with hill hold and horn function
- Can include auxiliary functions such as indicators, lights and windscreen wipers
- Available with interface or motor
- Safety system cuts acceleration when braking

Kivi LT12 Vertical Slider Control



The new LT12 transfers the acceleration and brake functions from the pedals to the wheel.

The LT12 consists of a downwards push brake lever and a slider. Push the lever down to brake, move the slider backwards to accelerate. The LT12 can be attached to the right or left of the steering column in many vehicles, depending on the users requirements.

Installation of the LT12 does not affect the airbag opening, does not prevent access to the driving controls and does not prevent users from driving the vehicle conventionally.

key features

- Easy Acceleration by pulling the slider and easy braking by pushing the lever
- Available with two or six buttons to give additional functionality
- Includes horn and hill holder
- Can include auxiliary functions such as indicators, lights and windscreen wipers
- Safety system cuts acceleration when braking

Paravan Space Drive



Space Drive is a driving system that is unrivalled throughout the world!

The Space Drive system allows users with low residual strength, minimum movement capabilities and even those without limbs to safely drive a vehicle.

With Space Drive, you activate the brake, accelerator, and steering wheel using driving aids controlled by microprocessors using triple redundancy. These transmit the signals in nanoseconds to a servo motor for the brake and accelerator and another for the steering ("Drive by wire" or "Steer by wire").

The Space Drive modules can be adjusted should a users condition change.



key features

- Active redundancy: motors with multiple safety features and full power, even if a control circuit fails
- Failure memory in several components
- Better braking at low speeds thanks to automatic adjustment to pedal travel and pedal power
- Parameters adjusted to suit each individual customer
- Optimum, flexible design suitable for all types of vehicles

Kivi PV1009 Secondary Control



Infra-red transmitter for secondary controls.

The PV1009 is an infra-red device which joins the service controls onto one keypad on the steering wheel. The keypad can be installed on either the right or the left of the steering wheel depending on the users requirements.

The device consists of a keypad and a handle which allows the steering wheel to be controlled whilst still allowing easy access to the controls for the: lights, low and high beam lights, flashing, windscreen wiper (three speeds available), rear electric windscreen wiper, front windscreen washer, direction indicators, hazard lights and horn.

The transmitter also has a "K" button where an optional function can be connected (subject to the verification of the vehicle model). The control can be positioned wherever the user requires.



key features

- Control position lights, low and high beam lights, flashing, windscreen wiper front and rear, front windscreen washer, direction indicators, hazard lights and horn.
- Extra button for additional control
- Illuminated keypad
- Available in three different colours
- EMC and crash test approved
- CE-marked



BraunAbility Mini Stamp Pedal Extension



The Menox Mini Stamp provides an extension of the pedals of up 3-9 cm (1-3 in).

The ease of movement allows for the pedal to be lowered into place and tucked away when not in use. Models are developed for both automatic and manual vehicles.

key features

- Suitable for automatic and manual vehicles
- Extend pedals up to 3-9cm
- Fold pedals away when not in use

BraunAbility Stamp Pedal Extension



The Menox Stamp Extension brings the original pedals closer and can be installed into both automatic and manual vehicles.

Adjustments can be made for distance, height and the desired space between pedals. They are also fit with a quick release, to be easily removed.

key features

- Suitable for automatic and manual vehicles
- Quick release option to easily remove the pedals
- Enables an extension of 10-30cm

BraunAbility Menox Pedals



The Menox pedal system can be adapted for the users needs.

Quick Release Left Foot Accelerator

Quick Release Left Foot Accelerator
The Menox Left Foot Accelerator enables users to accelerate with their left foot. The quick release pedal can be easily removed to allow for conventional driving. The Menox pedal is universal and can be installed into most vehicles.

Pedal Guard

The Menox Pedal Guard was designed to prevent accidental use of the foot pedals. The quick-release Pedal Guard is floor-mounted and available to cover either the accelerator or both accelerator and brake pedals.

Flip-Up Model

The Menox Left Foot Accelerator enables users to accelerate with their left foot. The Left Foot Accelerator is equipped with a hinge which flips the conventional pedal up when in use and vice versa.



BraunAbility Menox Steering Devices



The steering knob, the wheel spinner and the steering device are all the same product yet it has even more variants than names; to help you find the most comfortable way to steer your vehicle.

Steering Wheel Adapter

This is required to fit one of the devices listed below.

Model M-Standard

Uses the same handle as the Carospeed Menox Hand Control, for individuals seeking compatibility with the hand control. Available in 3 colour choices.

Model Low

The low design allows for the users fingers to be in constant reach of the turn signals, cruise control etc.. Available in 3 colour choices.

Model Round

The round knob is available in two dimensions; 50 mm and 40 mm. Available in 3 colour choices.

2- and 3-pin

A 2-pin or a 3-pin steering device for individuals with an impaired hand function. Can easily be reshaped to fit the users hand.

Model Ergo

Oval shaped ergonomic design.



Model M-Standard



Model Low



Model Round



2- and 3-pin



Model Ergo

Elap Various Aids

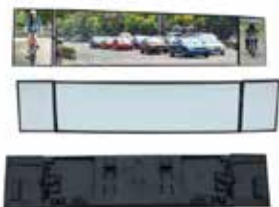

Panoramic Mirror- Anti-Dazzle

Enables the driver to have a panoramic view of the rear of the vehicle.

386mm x 80mm



Panoramic Mirror- Medium

Enables the driver to have a panoramic view of the rear of the vehicle.

300mm x 67mm



Panoramic Mirror- Large

Enables the driver to have a panoramic view of the rear of the vehicle.

430mm x 80mm



Seat Belt Grabber

The Seat Belt Grabber enables users to reach for a seat belt without stretching or twisting.



A-Pillar Grab Handle

The A-Pillar Grab Handle provides users with extra support when getting in and out of the vehicle.



Rear Seat Grab Handle

The Rear Seat Grab Handle helps users access the back of a vehicle by providing a comfortable and sturdy grab point.



Leg Lifter

Assists users when lifting their leg over the vehicle door sill.



Bumper Protector

Used to protect the bumper when loading a wheelchair/ scooter in and out of the boot.



Boot Strap

Designed to assist with closing the tailgate, where it is too high to reach.

Kivi Electric Headrest



The Electric headrest is designed for wheelchair users who wish to drive or travel from their wheelchair when the chair has no headrest.

It can be installed on either driver or passenger side and is operated using a rocker switch or handset.

The end position is programmable, so that the headrest complies with the back and head in an optimal way.

As a security feature, the headrest can only be operated when the vehicle is turned off and also has pinch protection if anything obstructs the movement.



key features

- Can be installed on either driver or passenger side
- Can be operated with a rocker switch or handset
- The end position of the headrest is programmable to suit the users requirements
- Pinch protection
- Height adjustable headrest

Elap E-Step



The E-Step is an electric side step which assists users getting in and out of a vehicle.

The E-Step can be installed on the driver or passenger side in either the front or mid row of many vehicles. The E-Step moves out from under the vehicle when the door is opened and returns underneath when the door is closed.

The E-Step supplied with LED technology which only illuminates the boarding path when the step is open meaning power is not wasted.



key features

- Available in various sizes
- Can be installed on driver or passenger side on either the front or mid row
- SWL 250kg
- LED lighting when in operation
- Built in pinch protection with sensitivity control
- Manual override
- Stainless steel
- CE Marked

Elap E-Start



The E-Start comes with a universal fitting kit so can be installed into most vehicles.

The E-start is simple to use, press once to turn on the ignition, press the button and hold down the brake to start the engine. Press the button once to stop the engine.

key features

- Can be installed into most vehicles
- Simple and easy to use
- Combines one button operation
- Button can be positioned wherever the user requires

Elap Indicator Extension



The Elap Indicator/Wiper Extension extends the function of the indicator lever across to the opposite side of the steering wheel.

For drivers with limited movement in either arm, this can also be used to extend the stalk switch to a more comfortable position.

key features

- Stalk can be cut to the required length for the user
- Suitable for left or right hand use
- Easy to use
- Smooth, discreet design
- No permanent modification to the vehicle

BraunAbility Carobrake



Activate the parking brake at the touch of a button.

The Carobrake is a device that pulls the parking brake with a power of up to 2200N via an actuator, mounted inside or under the vehicle.

The Carobrake pulls the original parking brake wire of the vehicle.



BraunAbility Parking Brake Release



The Parking Brake Release is available in two pipe dimensions: tube diameters 35 mm and 40 mm.

The handle is made of soft black foam.

BraunAbility Crossit



A universal positioning belt system.

The Crossit is a universal postural belt system that can be used on any seat, provided there is an opening between the seat and the backrest. The belt is developed for both private users and for public transportation.

The belts can be crossed over the users chest or can be strapped vertically the chest buckle used to keep them fixed.

key features

- Universal - one size fits all
- Developed for both personal use and community transport
- The belts can be crossed over the users chest or strapped vertically
- No changes to the seat are required
- Easy to install
- Fits all seats which have a space between the seat base and the backrest
- Can be used with wheelchairs with a stable backrest
- Portable
- CE-marked

BraunAbility Careva



The Careva postural belts are designed for users who need extra support when seated in a vehicle seat or wheelchair. They provide users with extra support to sit in an upright position.

The Careva spinal belt is fastened vertically over the backrest and has three compatible options.

The Thoracic Belt fastens around the users chest and is available in four different sizes.

The Pelvic T-Belt fastens around the users waist and is available in three different sizes.

The Combi Harness fastens around the users shoulders and waist and is available in three different sizes.

A vehicles standard seat belt should always be used together with the Careva postural belt system.

The Careva can be used on any vehicle seat providing there is a opening between the seat base and backrest.

www.elap.co.uk

ELAP

Fort Street, Accrington, Lancashire BB5 1QG
Tel: +44 (0) 1254 871599 Email: enquiries@elap.co.uk



Certificate number 14395
ISO9001

Authorised dealer

Disclaimer: Descriptions are based on the information available during publication and are valid until further notice. We cannot guarantee the accuracy and completeness of the information given and therefore do not accept liability.